



September 7, 2010
Revised November 15, 2010
Job No. 064-0910extr

Extreme Technology's
4501 Industrial Access Rd.
Douglasville, GA 30134

Attention: Mr. Chuck Irby

Re: Design Calculations for Helical Piles
Jesters Creek Boardwalk, Morrow, GA

Magnum Geo-Solutions, on behalf of its client, Extreme Technology's, respectfully submits these revised design details and calculations for helical piles and lateral bracing system to be used at the above referenced project site. This submittal modifies our October 20, 2010 submittal taking into account comments by Mr. Jason Weckerly with Jacobs that are contained in his email dated November 11, 2010. The following has been modified from the October 20, 2010 submittal:

- A statement has been added to the general notes on sheet HP4 regarding the soil report and additional probing.
- The pile schedule on HP1 has been modified to clarify typical helices.
- Page 2 of 46 of the calculations is revised (now reflects page 18 of JJG drawings).
- A statement of experience is included below.

Extreme Technology's (Extreme) will be installing the piers. Extreme is an authorized and trained Magnum Piering, Inc. dealer and has been installing Magnum helical piles for the past 10 years. Extreme was the outstanding dealer of the year in 2001 and 2006 and continues to be an active installer and one of Magnum's best customers. Magnum helical piles have been used on a number of recent boardwalk projects including:

Minihaha Creek Boardwalk (429 piles)
Necedah National Wildlife Visitors Center Boardwalk (288 piles)
Warsaw Pedestrian Boardwalk (268 piles)
Eagle Trail Boardwalk (approx. 200 piles)
Harbor Drive Boardwalk (178 piles – in progress)
Rhodes Jordan Park Boardwalk (240 piles – in progress)

If there are questions or additional areas which need clarification, we will be happy to address them.

Sincerely,
MAGNUM GEO-SOLUTIONS, LLC

James A. Cherry, P.E.
Senior Engineer

Howard A. Perko, Ph.D., P.E.
Director of Engineering

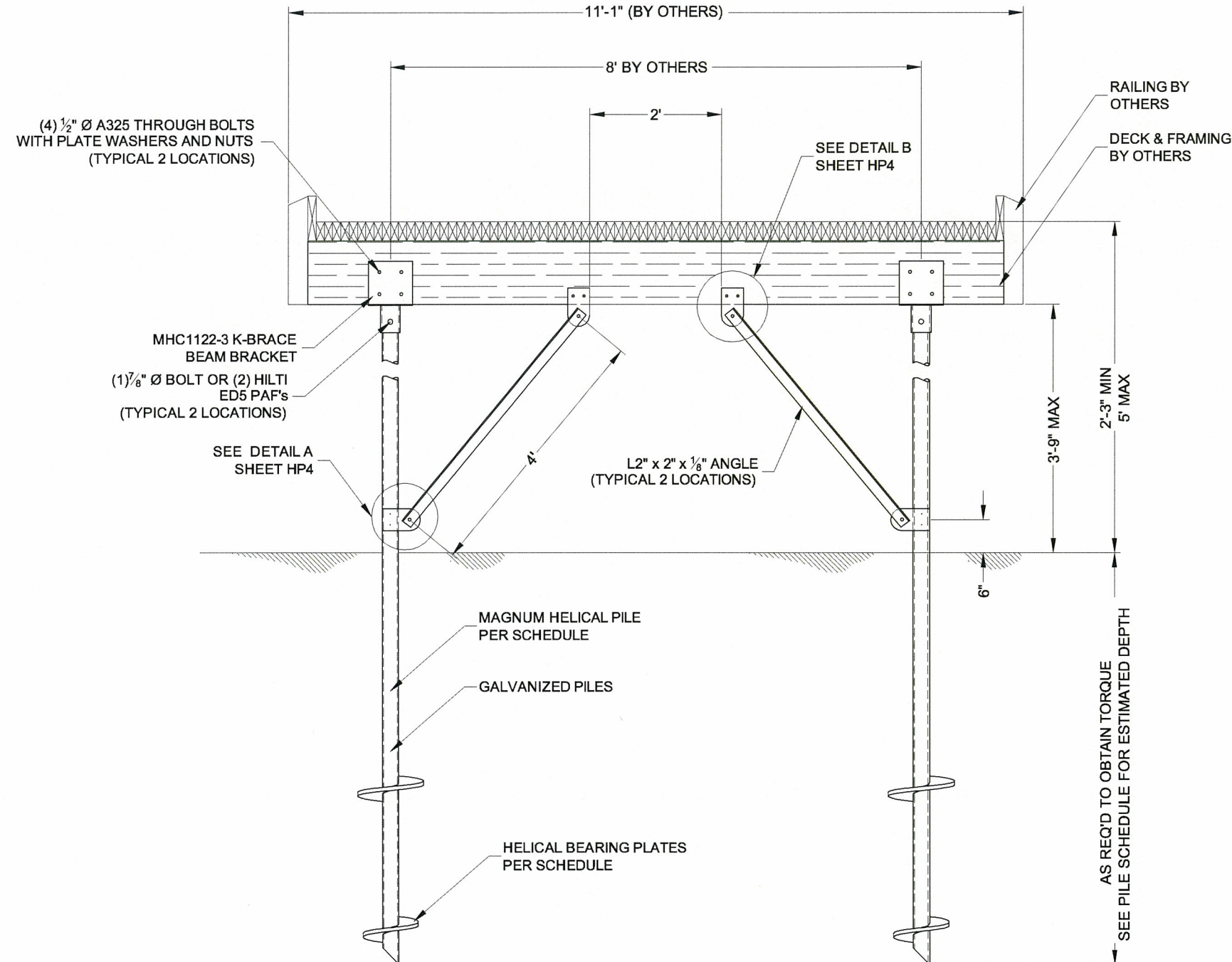

NOTE:
BRACES MAY BE PLACED ON EITHER SIDE OF
BEAM AND MAY CROSS FOR HEIGHTS LESS
THAN THAT SHOWN IN THE DETAIL.

ELEVATION TYPE B
(BETWEEN 2'-3" & 5' ABOVE GRADE)
Scale: 1/2"=1'

PROJECT NAME:
JESTERS CREEK PEDESTRIAN
PATHWAY BOARDWALK
CITY OF MORROW
CLAYTON COUNTY, GEORGIA

CLIENT:
EXTREME TECHNOLOGY'S
4501 INDUSTRIAL ACCESS RD
DOUGLASVILLE, GA 30134
Contact: Chuck Iby
770.942.6262

MAGNUM
GEO-SOLUTIONS, LLC
363 W. DRAKE RD., SUITE 1
FORT COLLINS, CO 80526
513-275-2442
800-822-7437
WWW.MAGNUMPIERING.COM

THESE DRAWINGS AND ACCOMPANYING SPECIFICATIONS, AS INSTRUMENTS OF SERVICE ARE THE EXCLUSIVE PROPERTY OF THE ENGINEER AND THEIR USE AND PUBLICATION SHALL BE RESTRICTED TO THE ORIGINAL SITE FOR WHICH THEY WERE PREPARED. REUSE, REPRODUCTION OR PUBLICATION BY ANY METHOD IN WHOLE OR IN PART IS PROHIBITED EXCEPT BY WRITTEN PERMISSION FROM THE ENGINEER. TITLE TO THESE PLANS AND SPECIFICATIONS SHALL REMAIN WITH THE ENGINEER WITHOUT PREJUDICE, AND VISUAL CONTACT WITH THEM SHALL CONSTITUTE PRIMA FACIE EVIDENCE OF ACCEPTANCE OF THESE RESTRICTIONS.

COPYRIGHT MAGNUM GEO-SOLUTIONS, LLC
ALL RIGHTS RESERVED.

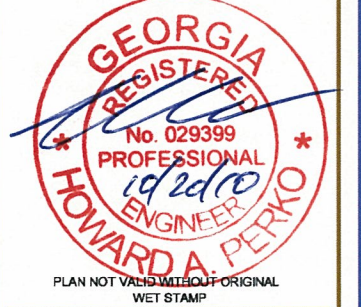

HELICAL PILE & BRACING
DETAILS

NO.	DATE	REVISION/ISSUE
01	10/20/10	CHANGED LAG SCREWS TO THROUGH BOLTS

DESIGNED BY: MMB DATE: 8/18/10
DRAWN BY: MMB SCALE: AS SHOWN
CHECKED BY: HAP
PROJECT No: 064-0810exdr

SHEET: HP2